

CODE: **PSACH 01244** v.1.2/IX **EN**
NAME: **PSACH 24VAC/4A/1x4A AC power supply for 1 rotating camera, ABS enclosure.**

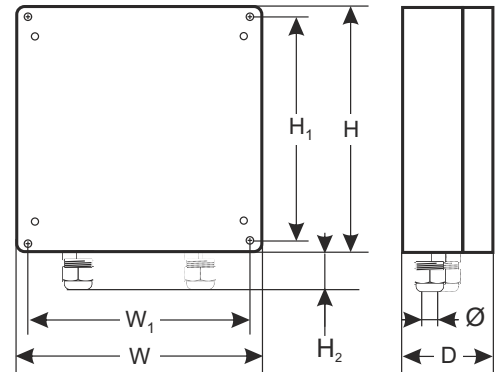
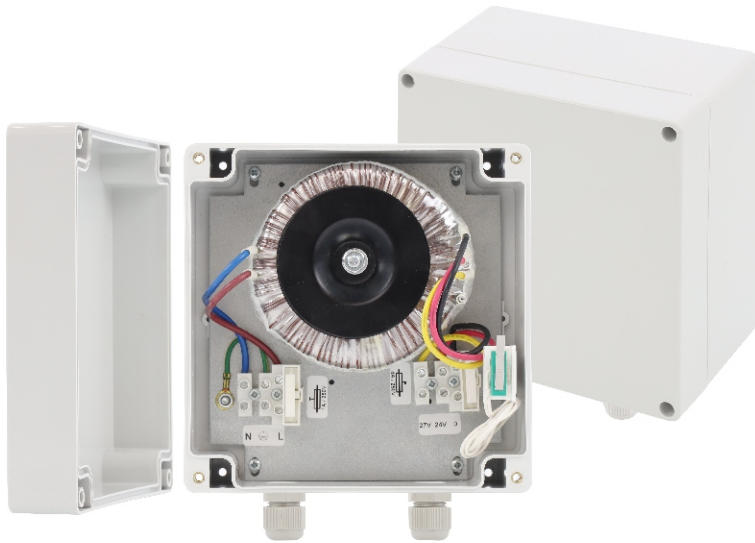

Features:

- ~24 V / 4 A or ~27 V / 3,7 A power output for powering camera
- power voltage ~ 230 V
- protections:
 - SCP short-circuit protection
 - OLP overload protection
 - OHP overheat protection
 - against tampering
- IP65 ABS, hermetic enclosure
- warranty – 2 years from production date

DESCRIPTION

AC/AC PSU intended for supplying devices requiring voltage AC of **~24 V** (U1= ~24 V / U2= ~27 V) and total capacity of **4 A@~24 V**. It features protections: short-circuit (SCP), overload (OLP), transformer overheat (OHP). PSU is housed in a ABS enclosure that features a microswitch indicating unwanted opening of the front door (faceplate).

TECHNICAL DATA	
Supply voltage	~ 230 V
Current consumption	0,5 A
Power frequency	50 Hz
Power of S PSU	100 VA max.
Output voltage	U1: ~23 – 28 V (100% load ÷ 0% load) U2: ~25,5 - 31,5 V (100% load ÷ 0% load)
Output current	4 A@~24 V max. or 3,7 A@~27 V max.
Short-circuit protection SCP	1x F 4A glass fuse - glass fuse damage requires fuse-element replacement
Overload protection OLP	circuit ~24 V: 1x F 4A circuit ~230 V: 1x T 1A
Overheat protection OHP	inside transformer
Sabotage protection: - TAMPER output indicating enclosure	- microswitch, NC contacts (enclosure closed), 0,5 A@ 50 V DC (max.)
Operating conditions	Temperature: -25°C ÷ +40°C
Enclosure	ABS, IP65, light grey
External dimensions of power supply unit	W=160, H=160, D=90 [+/- 2 mm]
Mounting dimensions of power supply unit	W ₁ =126, H ₁ =145 [+/- 2 mm]
Height glands	H ₂ =25 [mm]
Number of cable glands/ Ø cables	2szt. / 4÷8mm
Net/gross weight	2,2 / 2,3 [kg]
Closing	Cheese head screw x 4 (at front)
Declaration, warranty	CE, 2 years from production date
Notes	Enclosure has a removable mounting board with PSU systems.