

PSACH series power supply unit

AC power supply 24 V AC for 1 rotating camera, ABS enclosure

CODE: **PSACH 01246** v.1.1/V **EN**
 NAME: **PSACH 24VAC/6A/1x6A AC power supply for 1 rotating camera, ABS enclosure.**

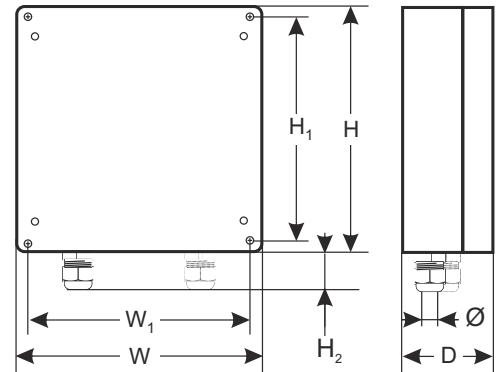
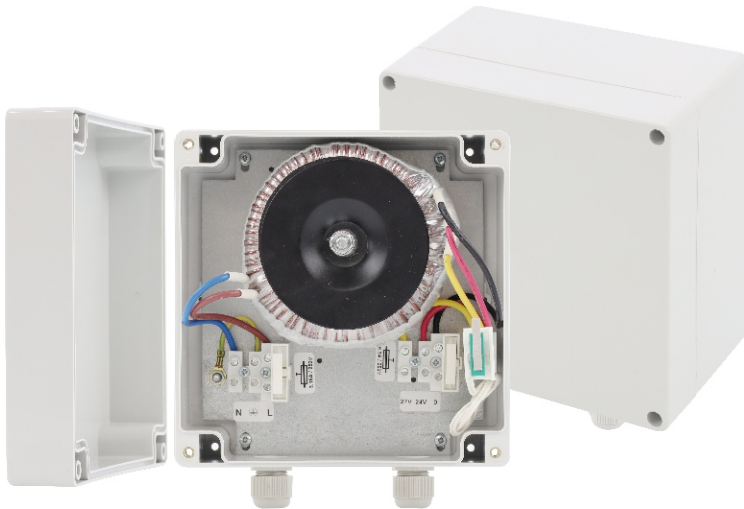

Features:

- ~24 V / 6 A or ~27 V / 5,5 A power output for powering camera
- power voltage ~ 230 V
- protections:
 - SCP short-circuit protection
 - OLP overload protection
 - OHP overhear protection
 - against tampering
- IP65 ABS, hermetic enclosure
- warranty – 2 years from production date

DESCRIPTION

AC/AC PSU intended for supplying devices requiring voltage AC of **~24 V** ($U_1 \sim 24 \text{ V}$ / $U_2 \sim 27 \text{ V}$) and total capacity of **6 A@~24 V**. It features protections: short-circuit (SCP), overload (OLP), transformer overhear (OHP). The PSU is housed in a ABS enclosure that features a microswitch indicating unwanted opening of the front door (faceplate).

| TECHNICAL DATA | |
|--|--|
| Supply voltage | ~ 230 V |
| Current consumption | 0,75 A |
| Power frequency | 50 Hz |
| Power of S PSU | 150 VA max. |
| Output voltage | U1: ~23 – 28 V (100% load ÷ 0% load) U2: ~25,5 - 31,5 V (100% load ÷ 0% load) |
| Output current | 6 A@~24 V max. or 5,5 A@~27 V max. |
| Short-circuit protection SCP | 1x T 6,3A glass fuse - glass fuse damage requires fuse-element replacement |
| Overload protection OLP | circuit ~24 V: 1x T 6,3A circuit ~230 V: 1x T 3,15A |
| Overheat protection OHP | inside transformer |
| Sabotage protection: - TAMPER output indicating enclosure | - microswitch, NC contacts (enclosure closed), 0,5 A@ 50 V DC (max.) |
| Operating conditions | Temperature: -25°C ÷ +40°C |
| Enclosure | ABS, IP65, light grey |
| External dimensions of power supply unit | W=160, H=160, D=90 [+/- 2 mm] |
| Mounting dimensions of power supply unit | W ₁ =126, H ₁ =145 [+/- 2 mm] |
| Height glands | H ₂ =25 [mm] |
| Number of cable glands/ Ø cables | 2szt. / 4÷8mm |
| Net/gross weight | 2,4 / 2,5 [kg] |
| Closing | Cheese head screw x 4 (at front) |
| Declaration, warranty | CE, 2 years from production date |
| Notes | Enclosure has a removable mounting board with PSU systems. |