

CODE: **RAKU3** v1.0/l
 NAME: **Battery enclosure 4x17Ah for RACK 19" cabinets.**

EN

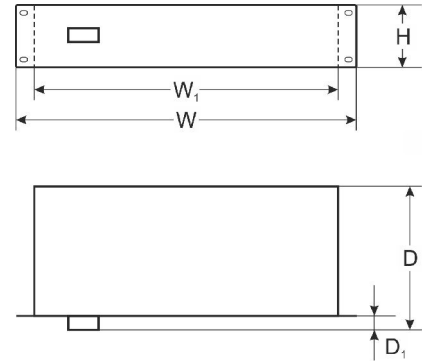

INTENDED USE

The RAKU3 battery enclosure is designed for installation 1÷4 of 7Ah / 17Ah/12V (SLA) batteries inside RACK 19" cabinets. Battery outputs are located at the front panel of the housing.

SPECIFICATIONS

Battery compartment	4x17Ah/12V (SLA) max.
Output load	20A max.
Output voltage	60V DC max.
Operating conditions	2nd environmental class, -10°C+40°C, ensure free air flow around the enclosure. Relative humidity 20% ... 90%, no condensation
Mounting dimensions	W=19", H=2U, D=425
Dimensions	W=483, W ₁ =435, H=88, D=425, D ₁ =82 [+/- 2mm]
Enclosure	Steel plate 1,2 mm, color RAL 9005, IP20
Net/gross weight	5,0kg / 5,7kg
Storage temperature	-20°C...+60°C
Notes	- Six-point butt mounting to RACK profiles - The set includes 6 M6 screws + cage nuts + plastic washer
Warranty	2 years from the production date